

There are three menus available when the machine is powered OFF

Engineers settings menu

Press and hold the **UP,DOWN** and **PROGRAM** button together for more than 8 seconds.

The display will change and show the engineers menu.

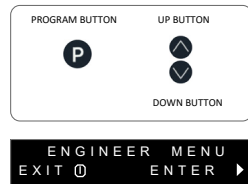

Engineers test menu

Press and hold both the **UP**, **DOWN** and **START** button together for more than 8 seconds.

The display will change and show the engineers test menu.
Page x

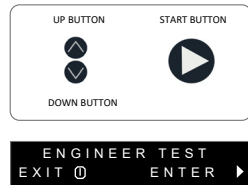

Information menu

Press and hold the **DOWN** button to for more than 4 seconds.

The display will change and show the information menu.
Page x

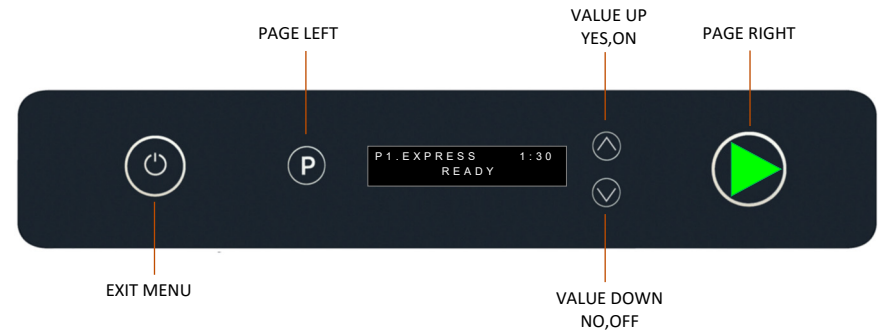
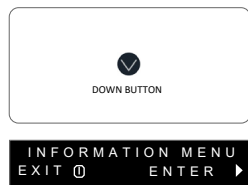

There are three menus available when the machine is powered ON

Managers settings menu

Press and hold the **UP,DOWN** button together for more than 8 seconds.

The display will change and show the managers menu.
Page x



Information menu

Press and hold the **DOWN** button to for more than 4 seconds.

The display will change and show the information menu.
Page x

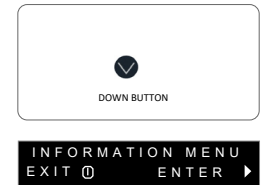

Show temperatures

Press and hold the **UP** button to show last wash cycle temperatures.

Continue to hold the **UP** button to show the current temperatures.

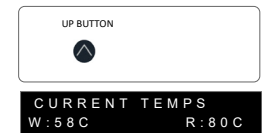

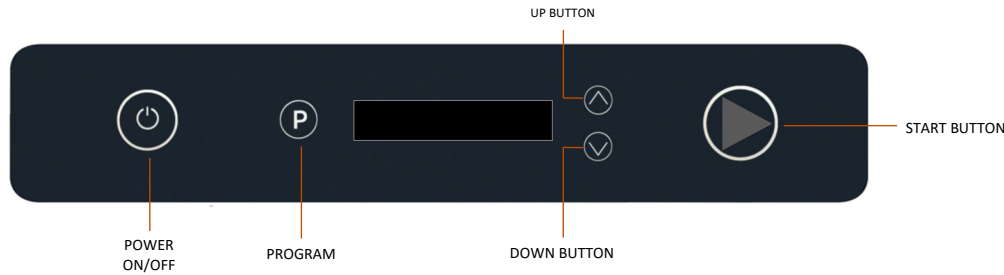

When the machine is POWERED OFF the engineers menu can be accessed.

Press and hold the **UP,DOWN** and **PROGRAM** button together for more than 8 seconds.

The display will change and show the engineers menu

Press the **START** button to enter the first page of the managers menu
Continue to press the **START** button to advance to the next page.

Press **PROGRAM** button for the previous page.

To exit the menu at any time you can press the **POWER ON** button
All changes will be saved.

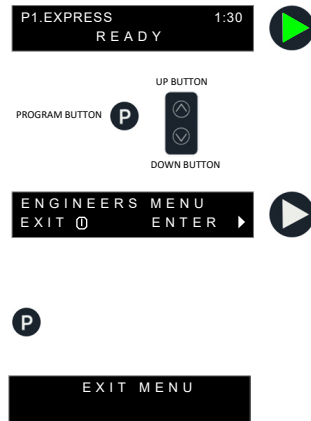

PAGE	DISPLAY	PARAMETER
1	ENGINEERS MENU EXIT ⏪ ENTER ▶	Managers menu . Press ▶ button to advance to the next page. Press P button for previous page. Press ▲▼ change values with the UP and DOWN buttons Press ⏻ button at any time to exit the menu,. All changes will be saved.
2	DETERGENT PRIME RINSE AID PRIME	Press ▲ button to prime detergent. Press ▼ button to prime rinse aid.
3	DETERGENT FIRST FILL 60 ml	Increase or decrease ▲▼ (ml) volumes of detergent chemical on first fill.
4	DETERGENT PER WASH 10 ml	Increase or decrease ▲▼ (ml) volumes of detergent per wash cycle.
5	RINSE AID PER WASH 1.2 ml	Increase or decrease ▲▼ (ml) volumes of rinse aid per wash cycle.
6	WASH FINISH TONE LOUD	Wash finish tone volume can be change. ▲▼ LOUD,QUIET,OFF
7	DOOR AUTO-START NO	Start the wash cycle when the door is closed automatically. ▲▼ YES,NO
8	ENERGY SAVE STANDBY 60 Min	Time period before the machine goes to standby saving energy. ▲▼ OFF, 1 - 60 minutes.
9	WATER HARDNES NOT FEATURED WATER HARDNES 100-150 PPM	<i>Only available on selected models with internal water softener system.</i> Select the hardness of the incoming water supply. ▲▼ 100 — 150 ppm 150 — 200 ppm 200 — 300 ppm 300 — 400 ppm 400 — 500 ppm
10	SOFTENER FLUSH NOT FEATURED SOFTENER FLUSH EXTENDED OFF	<i>Only available on selected models with internal softener system.</i> Extends the flushing of the softener system if the water pressure or flow rate is very poor. Adds an extra 2 minutes to the softener regeneration time. Select ON,OFF ▲▼
11	P1: EXPRESS VISIBLE YES	Program P1: Can be visible or hidden when selecting wash cycle programs. YES,NO ▲▼
12	P2: QUICK VISIBLE YES	Program P2: Can be visible or hidden when selecting wash cycle programs. YES,NO ▲▼
13	P3: STANDARD ALWAYS VISABLE	Program P3: Can not be hidden and always visible when selecting wash programs.
14	P4: EXTENDED VISIBLE YES	Program P4: Can be visible or hidden when selecting wash cycle programs. YES,NO ▲▼
15	P5: MY WASH VISIBLE YES	Program P5: Can be visible or hidden when selecting wash cycle programs. YES,NO ▲▼

16	<p>MY WASH SETTINGS WASH TEMP 60C</p>	<p>My Wash. User defined wash cycle for customised or specific tasks. Washing temperature during the wash phase.</p> <p>⬆ Increase, Decrease the washing temperature 20C - 70C</p>
17	<p>MY WASH SETTINGS WASHING 2 Min</p>	<p>My Wash. User defined wash cycle for customised or specific tasks. Washing time.</p> <p>⬆ Increase, Decrease the length of washing 1 - 8 Minutes</p>
18	<p>MY WASH SETTINGS REST 5 Sec</p>	<p>My Wash. User defined wash cycle for customised or specific tasks. Rest period after washing to allow wash water to drip of the items in the basket.</p> <p>⬆ Increase, Decrease the rest time 5 - 10 seconds</p>
19	<p>MY WASH SETTINGS RINSE TEMP 83C</p>	<p>My Wash. User defined wash cycle for customised or specific tasks. Final rinsing temperature.</p> <p>⬆ Increase, decrease the rinse temperature 40C - 90C</p>
20	<p>MY WASH SETTINGS RINSING 10 Sec</p>	<p>My Wash. User defined wash cycle for customised or specific tasks. Rinsing time</p> <p>⬆ Increase,decrease the Rinsing time. 8 - 16 seconds</p>
21	<p>MY WASH SETTINGS DRIP DOWN 5 Sec</p>	<p>My Wash. User defined wash cycle for customised or specific tasks. Drip down time to allow rinse water to drip before cycle finishes.</p> <p>⬆ Increase, decrease the drip down time . 3 - 10 seconds</p>
22	<p>SWITCH RINSING NOT FEATURED</p>	<p><i>Only available on selected models with internal switch rinse system.</i></p> <p>Switch rinse system delivers controlled water volumes and time periods to the upper and lower arms for Improved rinse time contact timed. can reduced water usage. There are three patterns available.</p> <p>Select the switch rinse pattern. ⬆</p>
	<p>SWITCH RINSING OFF</p>	<p>Providing continuous rinse to both upper and lower arms.</p>
	<p>SWITCH RINSING UP=70% DOWN=30%</p>	<p>Provides extra rinsing to the inside of cups and glasses from the lower rinse arm.</p>
	<p>SWITCH RINSING UP=50% DOWN=50%</p>	<p>Reduces water usage by first rinsing up and then rinsing down.</p>
	<p>SWITCH RINSING UP=30% DOWN=70%</p>	<p>Provides extra rinsing down over plates and cutlery.</p>

PAGE	DISPLAY	PARAMETER
23	<p>COLD RINSE SPRAY NOT FEATURED</p>	<p><i>Only available on selected models with internal cold rinse system.</i></p> <p>Cold rinse system. At the end of the normal washing cycle the cold rinse system delivers cold water over the glasses to bring the temperature down quickly ready for service. There are two patterns available. <i>Note: Not recommended for fine crystal or delicate glassware.</i></p> <p>Select the cold rinse spray pattern. ⬆</p>
	<p>COLD RINSE SPRAY OFF</p>	<p>Cold rinse spray system turned .off</p>
	<p>COLD RINSE SPRAY 6 Sec</p>	<p>Cold rinse system sprays for 6 seconds and then the wash cycle finishes.</p>
	<p>COLD RINSE SPRAY 10 Sec</p>	<p>Cold rinse system sprays for 10 seconds and then the wash cycle finishes.</p>
24	<p>THERMOLOCK RINSE ON</p>	<p>When thermolock rinse on the machine will continue to wash until the rinse water has reached the set temperature and only rinse at the set temperature. May increase wash times.</p> <p>CAUTION! If the thermolock is set to OFF the machine will wash and then rinse without checking the rinse temperature and potentially start to rinse when the rinse water has not fully heated.</p> <p>⬆ ON ⬇ OFF</p>
	<p>THERMOLOCK (CAUTION!) OFF</p>	<p>ON: The thermolock guarantees the temperature of the rinse boiler is achieved before beginning the rinse.</p> <p>OFF: The machine will wash and rinse without checking temperatures and could have reduced rinse temperatures after some time.</p>
25	<p>THERMOLOCK STARTUP ON</p>	<p>When thermolock wash is on the machine will fill the wash and continue to heat until the wash temperature is reached.</p> <p>⬆ ON ⬇ OFF</p> <p>The machine will not be READY and unable to wash until fully heated.</p>
26	<p>DUEL ELEMENTS (CAUTION!) ON</p>	<p>Both the rinse boiler element and the wash tank element will come on at same time. This increases the Amps required for the machine.</p> <p>Factory default: Duel elements is OFF</p> <p>⬆ ON ⬇ OFF</p> <p>CAUTION: check the machine has a suitable sized mains cable and the supply is sufficient for the increased power load. Check the data plate for total loading.</p>
27	<p>MODEL TYPE DISHWASHER</p>	<p>The machine model type can be changed from the original factory configuration.</p> <p>⬆ Select the change in model type. Glasswasher,Dishwasher</p>
	<p>MODEL TYPE GLASSWASHER</p>	<p>Key settings will be modified and temperatures and cycle times will change</p>

28	T/OUT WASH ELE STARTUP 55 Min	Time out for the wash tank element heating. If the time out exceeds the time set a fault will be generated to alert a possible issue with the wash tank heating element.
29	OFFSET WASH PROBE 0 C	Offset the positioning of the probe related to the heat source. Example the wash tank probe is monitoring the temperature of the outside of the wash tank and this will be different to the actual temperature of the wash tank water. Careful calibration of temperatures means there needs to be an offset of 5c
30	T/OUT RINSE ELE STARTUP 12 Min	Time out for the rinse boiler element heating. If the time out exceeds the time set a fault will be generated to alert a possible issue with the rinse boiler element heating element.
31	OFFSET RINSE PROBE 0 C	Offset the positioning of the probe related to the heat source. Example the rinse boiler probe is monitoring the temperature of the inside pocket of the boiler cylinder and this will be different to the actual temperature of the rinse boiler water. Careful calibration of temperatures means there needs to be an offset of 5c
32	WASH TANK FILL T/OUT 8 Min	Time out for the filling of the wash tank. If the time out exceeds the time set a fault will be generated to alert a possible issue with the water flow rate, pressure, or restriction.
33	WASH TANK DRAIN T/OUT 5 Min	Time out for the draining of the wash tank. If the time out exceeds the time set a fault will be generated to alert a possible issue with the water the drain pump,blockage.
34	SHOW TEMPERATURES ON SHOW TEMPERATURES WASHING OFF	Show or hide wash and rinse temperatures during washing. NOTE: Temperatures will vary during the wash cycle as the machine heats while washing. <ul style="list-style-type: none"> ON OFF
35	CHEMICAL VALUES LOCKED NO CHEMICAL VALUES LOCKED YES	Chemical dosing values can be changed in the managers menu. Chemical dosing values are locked and can not be changed in the managers menu. NOTE: Unlock before changing chemical values.

PAGE	DISPLAY	PARAMETER
36	CLEAR FAULT LIST ARE YOU SURE 0 CLEAR FAULT LIST FAULTS CLEARED	Press and hold UP and DOWN buttons together to clear all data from the fault list. There is an 8 second count down before the data is cleared. Release the UP and DOWN buttons if you do not want to clear the fault list
37	RESTORE DEFAULTS PRESS 8 SEC RESTORE DEFAULTS ARE YOU SURE 0 RESTORED	Press and hold UP and DOWN buttons together to restore the machine to factory Settings There is an 8 second count down before the data is restored. Release the UP and DOWN buttons if you do not want to restore. Original factory setting will be restored and the machine will switch off.

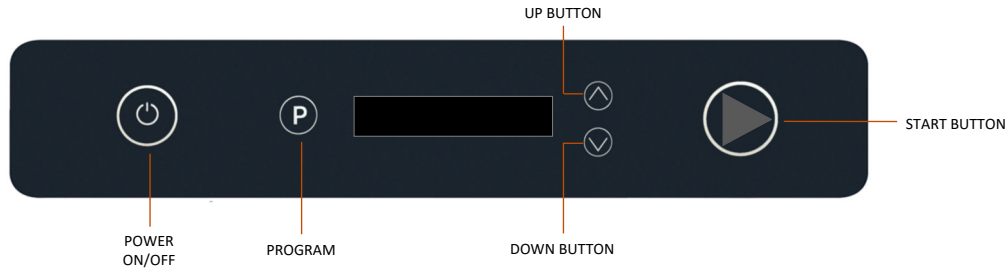

When the machine is POWERD OFF the engineers test menu can be accessed.

Press and hold both the **UP** , **DOWN** and **START** button together for more than 8 seconds.

The display will change and show the engineers test menu.

Press the **START** button to enter the first page of the menu
Continue to press the **START** button to advance to the next page.

Press **PROGRAM** button for the previous page.

To exit the menu at any time you can press the **POWER ON** button.
All changes will be saved.

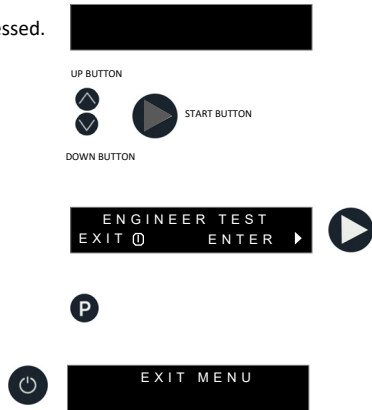

PAGE	DISPLAY	PARAMETER
1	MANAGER MENU EXIT [P] ENTER [▶]	Managers menu . Press [▶] button to advance to the next page. Press [P] button for previous page. Press [▲] [▼] to test the component with the UP or DOWN buttons. Press [⏻] button at any time to exit the menu,. All changes will be saved.
2	WASH PUMP ON WASH PUMP CLOSE DOOR OFF	Press the [▲] UP button to activate the wash pump. If the door is open the wash pump can not be tested.
3	DRAIN PUMP ON	Press the [▲] UP button to activate the drain pump. The door can be open or closed during testing.
4	RBP PUMP ON	Press the [▲] UP button to activate the rinse booster pump. If the door is open the rinse booster pump can not be tested.
5	FILL VALVE ON	Press the [▲] UP button to activate the fill valve water solenoid. WARNING: The fill valve water solenoid can activate with the door open or closed. Close the door at the start of the test.
6	ELEMENT RINSE BOILER ON ELEMENT NO RINSE WATER! OFF	Press the [▲] UP button to activate the rinse boiler element from contactor. If there is no water in the rinse boiler the component will not activate.
7	ELEMENT WASH TANK ON ELEMENT NO WASH WATER! OFF	Press the [▲] UP button to activate the wash tank element from HV relay. If there is no water in the wash tank the component will not activate.
8	DETERGENT RINSE AID ON	Press the [▲] UP button to activate the detergent pump. Press the [▼] DOWN button to activate the rinse aid pump. Both the detergent and rinse aid pumps can activate together.
9	SWITCH RINSE VALVE DOWN ON	<i>Only available on selected models with switch rinse system.</i> Press the [▲] UP button to activate the N/O solenoid. Component will be tested without water being present.
10	SWITCH RINSE VALVE UP ON	<i>Only available on selected models with switch rinse system.</i> Press the [▲] UP button to activate the N/O solenoid. Component will be tested without water being present.

PAGE	DISPLAY	PARAMETER
11		<i>Only available on selected models with internal water softener system.</i>
	SALT VALVE ON DIVERT VALVE ON	Press the UP button to activate the salt solenoid valve. Press the DOWN button to activate the divert solenoid valve. Both the salt solenoid valve and divert solenoid valve can activate together
12	DOOR REED SWITCH OPEN DOOR REED SWITCH CLOSED	The reed switch detects the door open. The reed switch detects the door closed.
13	RINSE PROBE 78C TEST	Press and hold the UP button. The probe will self test. The current temperature of the rinse boiler probe will be shown You will here an audio pulse during testing and the system will show the results.
	RINSE PROBE 78C PROBE OK	Probe is working.
	RINSE PROBE 78C NOT CONNECTED	Probe disconnected or the cable is severed or compromised.
	RINSE PROBE 0C OUT OF RANGE +	Probe reports high temperatures out of range + Probe reports low temperatures out of range -
14	WASH TANK 60C TEST	Press and hold the UP button. The probe will self test. The current temperature of the wash tank probe will be shown You will here an audio pulse during testing and the system will show the results.
	WASH TANK 60C PROBE OK	Probe is working.
	WASH TANK 60C NOT CONNECTED	Probe disconnected or the cable is severed or compromised.
	WASH TANK 0C OUT OF RANGE	Probe has failed.
15	PRESSURE SWITCH WASH TANK HIGH PRESSURE SWITCH WASH TANK LOW	The wash tank pressure switch reports there is water in the wash tank. The wash tank pressure switch reports there is no water in the wash tank.
16		<i>Only available on selected models with internal water softener system.</i>
	PRESSURE SWITCH BREAK TANK HIGH PRESSURE SWITCH BREAK TANK LOW	The break tank pressure switch reports there is water in the rinse boiler and break tank. The break tank pressure switch reports there is no water break tank.
17	RGB LED TEST	Press the UP button to sequence through all seven led colors

PAGE	DISPLAY	PARAMETER
18	SOUND TEST	Press the UP button to start the sound test.
19		<i>Only available on selected models with internal water softener system.</i>
	SALT POT SENSOR POT EMPTY	Shows the salt pot reed switch detects no saline solution (no salt)
	SALT POT SENSOR POT FULL	Shows the salt pots reed switch detects there is saline solution (salt)
20		<i>Only available on selected models with internal water softener system.</i>
	FORCE REGEN TEST PRESS 8 Sec	Press and hold UP and DOWN buttons together to start the regeneration of the softener.
	FORCE REGEN TEST ARE YOU SURE 8	There is an 8 second count down before the test. Release the UP and DOWN buttons if you do not want to start the test.
	CLOSE DOOR	The test will start and check if the door is closed
		Each stage of the regeneration will show the working process and time remaining . Each stage may vary in process and time depending on the settings in the managers menu.
	SALT 1 3:27 PLEASE WAIT	Salt stage.
	REST 1 1:12 PLEASE WAIT	Reaction resting stage 1.
	SALT STIR 1:26 PLEASE WAIT	Salt stir.
	RESIN STIR 1:26 PLEASE WAIT	Resin stir
	REST 2 1:12 PLEASE WAIT	Reaction resting stage 2.
	FLUSH 1 4:26 PLEASE WAIT	Flush and cleaning of the resins.
	TEST COMPLETE	At the end of the test it will return back to the engineer test menu.
	CLOSE DOOR	The test will be paused if the door is opened.
	TEST CANCELED	To cancel the test at any time open the door and press and hold for more 8 seconds and returns to the engineers test menu.
21		<i>Only available on selected models with internal water softener system.</i>
	REFEN VALUE =20 WASH COUNT =6	Shows the calculation of the user regen level and counting of wash cycle until regeneration Triggers.
22	ENGINEER SUPPORT TEL:01749 870055	Call engineers support line during normal office hours.

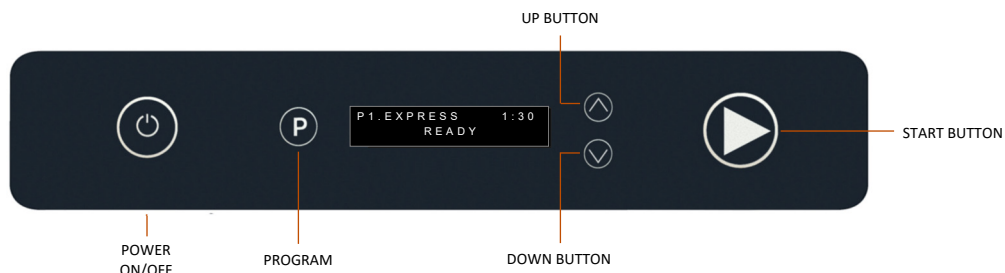

When the machine is READY and not during washing the managers menu can be accessed.

Press and hold both the **UP** button and **DOWN** button to for more than 8 seconds.

The display will change and show the managers menu

Press the **START** button to enter the first page of the managers menu Continue to press the **START** button to advance to the next page.

Press **PROGRAM** button for the previous page.

To exit the menu at any time you can press the **POWER ON** button All changes will be saved.

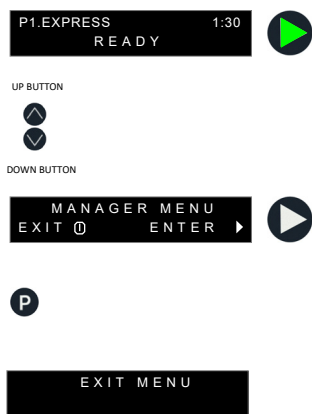

PAGE	DISPLAY	PARAMETER
1	MANAGER MENU EXIT ⏪ ENTER ▶	Managers menu . Press ▶ button to advance to the next page. Press P button for previous page. Press ▲▼ change values with the UP and DOWN buttons Press ⏻ button at any time to exit the menu,. All changes will be saved.
2	DETERGENT PRIME RINSE AID PRIME	Press ▲ button to prime detergent. Press ▼ button to prime rinse aid.
3	DETERGENT FIRST FILL 60 ml	Increase or decrease ▲▼ (ml) volumes of detergent chemical on first fill.
4	DETERGENT PER WASH 10 ml	Increase or decrease ▲▼ (ml) volumes of detergent per wash cycle.
5	RINSE AID PER WASH 1.2 ml	Increase or decrease ▲▼ (ml) volumes of rinse aid per wash cycle.
6	WASH FINISH TONE LOUD	Wash finish tone volume can be change. ▲▼ LOUD,QUIET,OFF
7	DOOR AUTO-START NO	Start the wash cycle when the door is closed automatically. ▲▼ YES,NO
8	ENERGY SAVE STANDBY 60 Min	Time period before the machine goes to standby saving energy. ▲▼ OFF, 1 - 60 minutes.
9	WATER HARDNES NOT FEATURED WATER HARDNES 100-150 PPM	<i>Only available on selected models with internal water softener system.</i> Select the hardness of the incoming water supply. ▲▼ 100 — 150 ppm 150 — 200 ppm 200 — 300 ppm 300 — 400 ppm 400 — 500 ppm
10	SOFTENER FLUSH NOT FEATURED SOFTENER FLUSH EXTENDED OFF	<i>Only available on selected models with internal softener system.</i> Extends the flushing of the softener system if the water pressure or flow rate is very poor. Adds an extra 2 minutes to the softener regeneration time. Select ON,OFF ▲▼
11	P1: EXPRESS VISIBLE YES	Program P1: Can be visible or hidden when selecting wash cycle programs. YES,NO ▲▼
12	P2: QUICK VISIBLE YES	Program P2: Can be visible or hidden when selecting wash cycle programs. YES,NO ▲▼
13	P3: STANDARD ALWAYS VISABLE	Program P3: Can not be hidden and always visible when selecting wash programs.
14	P4: EXTENDED VISIBLE YES	Program P4: Can be visible or hidden when selecting wash cycle programs. YES,NO ▲▼
15	P5: MY WASH VISIBLE YES	Program P5: Can be visible or hidden when selecting wash cycle programs. YES,NO ▲▼

16	<p>MY WASH SETTINGS WASH TEMP 60C</p>	<p>My Wash. User defined wash cycle for customised or specific tasks. Washing temperature during the wash phase.</p> <p>⬆️ Increase, Decrease the washing temperature 20C - 70C</p>
17	<p>MY WASH SETTINGS WASHING 2 Min</p>	<p>My Wash. User defined wash cycle for customised or specific tasks. Washing time.</p> <p>⬆️ Increase, Decrease the length of washing 1 - 8 Minutes</p>
18	<p>MY WASH SETTINGS REST 5 Sec</p>	<p>My Wash. User defined wash cycle for customised or specific tasks. Rest period after washing to allow wash water to drip of the items in the basket.</p> <p>⬆️ Increase, Decrease the rest time 5 - 10 seconds</p>
19	<p>MY WASH SETTINGS RINSE TEMP 83C</p>	<p>My Wash. User defined wash cycle for customised or specific tasks. Final rinsing temperature.</p> <p>⬆️ Increase, decrease the rinse temperature 40C - 90C</p>
20	<p>MY WASH SETTINGS RINSING 10 Sec</p>	<p>My Wash. User defined wash cycle for customised or specific tasks. Rinsing time</p> <p>⬆️ Increase, decrease the Rinsing time. 8 - 16 seconds</p>
21	<p>MY WASH SETTINGS DRIP DOWN 5 Sec</p>	<p>My Wash. User defined wash cycle for customised or specific tasks. Drip down time to allow rinse water to drip before cycle finishes.</p> <p>⬆️ Increase, decrease the drip down time . 3 - 10 seconds</p>
22	<p>SWITCH RINSING NOT FEATURED</p>	<p><i>Only available on selected models with internal switch rinse system.</i></p> <p>Switch rinse system delivers controlled water volumes and time periods to the upper and lower arms for Improved rinse time contact timed. can reduced water usage. There are three patterns available.</p> <p>Select the switch rinse pattern. ⬆️</p>
	<p>SWITCH RINSING OFF</p>	<p>Providing continuous rinse to both upper and lower arms.</p>
	<p>SWITCH RINSING UP = 70% DOWN = 30%</p>	<p>Provides extra rinsing to the inside of cups and glasses from the lower rinse arm.</p>
	<p>SWITCH RINSING UP = 50% DOWN = 50%</p>	<p>Reduces water usage by first rinsing up and then rinsing down.</p>
	<p>SWITCH RINSING UP = 30% DOWN = 70%</p>	<p>Provides extra rinsing down over plates and cutlery.</p>

PAGE	DISPLAY	PARAMETER
23	<p>COLD RINSE SPRAY NOT FEATURED</p>	<p><i>Only available on selected models with internal cold rinse system.</i></p> <p>Cold rinse system. At the end of the normal washing cycle the cold rinse system delivers cold water over the glasses to bring the temperature down quickly ready for service. There are two patterns available. <i>Note: Not recommended for fine crystal or delicate glassware.</i></p> <p>Select the cold rinse spray pattern. ⬆️</p>
	<p>COLD RINSE SPRAY OFF</p>	<p>Cold rinse spray system turned .off</p>
	<p>COLD RINSE SPRAY 6 Sec</p>	<p>Cold rinse system sprays for 6 seconds and then the wash cycle finishes.</p>
	<p>COLD RINSE SPRAY 10 Sec</p>	<p>Cold rinse system sprays for 10 seconds and then the wash cycle finishes.</p>
24	<p>THERMOLOCK RINSE ON</p>	<p>When turned on the machine will continue to wash until the rinse water has reached the set temperature and only rinse at the set temperature. May increase wash times.</p> <p>CAUTION! If the thermolock is set to OFF the machine will wash and then rinse without checking the rinse temperature and potentially start to rinse when the rinse water has not fully heated.</p>
	<p>THERMOLOCK (CAUTION!) OFF</p>	<p>Select On or OFF ⬆️</p> <p>ON: The thermolock guarantees the temperature of the rinse boiler is achieved before beginning the rinse.</p> <p>OFF: The machine will wash and rinse without checking temperatures and could have reduced rinse temperatures after some time.</p>
1	<p>MANAGER MENU EXIT ENTER</p>	<p>End of the managers menu The managers menu has returned to the start position of the menu.</p>

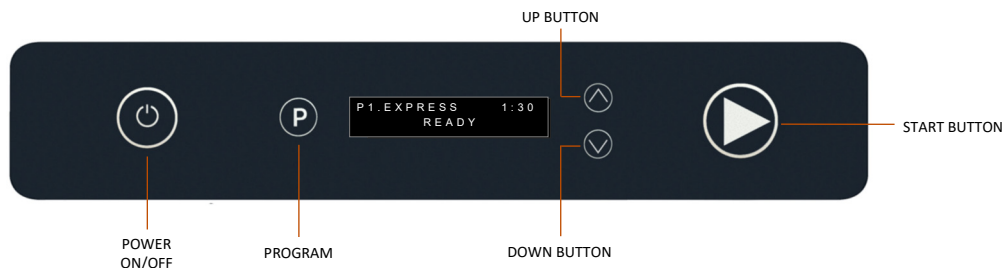

When the machine is READY and not during washing the information menu can be accessed.

Press and hold the **DOWN** button to for more than 4 seconds.

The display will change and show the information menu.

Press the **START** button to enter the first page of the information menu Continue to press the **START** button to advance to the next page.

Press **PROGRAM** button for the previous page.

To exit the menu at any time you can press the **POWER ON** button All changes will be saved.

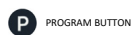

PAGE	DISPLAY	PARAMETER																		
1	INFORMATION MENU EXIT 0 ENTER 1	<p>Information menu:</p> <p>Press button to advance to the next page.</p> <p>Press for previous page.</p> <p>Press change or view values with the UP and DOWN buttons.</p> <p>Press button at any time to exit the menu,. All changes will be saved.</p>																		
2	MODEL TYPE MODEL TYPE DW UC A IS	<p>Model type:</p> <p>The machine checks all features fitted and displays the results</p> <table border="1"> <thead> <tr> <th>KEY</th> <th>DESCRIPTION</th> </tr> </thead> <tbody> <tr> <td>DW</td> <td>DISHWASHER</td> </tr> <tr> <td>GW</td> <td>GLASSWASHER</td> </tr> <tr> <td>UC</td> <td>UNDERCOUNTER</td> </tr> <tr> <td>PT</td> <td>PASS THROUGH</td> </tr> <tr> <td>A</td> <td>BREAK TANK</td> </tr> <tr> <td>IS</td> <td>INTERNAL SOFTENER</td> </tr> <tr> <td>SW</td> <td>SWITCH RINSE</td> </tr> <tr> <td>CR</td> <td>COLD RINSE</td> </tr> </tbody> </table> <p>Example: Dishwasher undercounter with break tank and internal softener fitted</p>	KEY	DESCRIPTION	DW	DISHWASHER	GW	GLASSWASHER	UC	UNDERCOUNTER	PT	PASS THROUGH	A	BREAK TANK	IS	INTERNAL SOFTENER	SW	SWITCH RINSE	CR	COLD RINSE
KEY	DESCRIPTION																			
DW	DISHWASHER																			
GW	GLASSWASHER																			
UC	UNDERCOUNTER																			
PT	PASS THROUGH																			
A	BREAK TANK																			
IS	INTERNAL SOFTENER																			
SW	SWITCH RINSE																			
CR	COLD RINSE																			
3	FIRMWARE MAXIMA V.02	Shows the current firmware version installed.																		
4	TOTAL WASHES 001968	Total wash cycles from first installation.																		
5	AVERAGE WASHES 18 PER SESSION	Calculates the average of washes each session.																		
6	SOFTENER REGENS TOTAL 317	Total softener regenerations from first installation.																		
7	SOFTENER REGENS W/OUT SALT 0/30	Calculates how many softener regenerations out of every 30 regenerations had no salt																		
8	FAULT No. 1 NONE FAULT No. 2 NONE FAULT No. 3 NONE FAULT No. 4 NONE FAULT No. 5 NONE FAULT No. 6 NONE FAULT No. 7 NONE FAULT No. 8 NONE FAULT No. 9 NONE FAULT No. 10 NONE	<p>Any faults during use will be stored and displayed There is a total of the last 10 faults s Fault No. 1 will be the most recent fault recorded and fault 10 the oldest.</p> <p>If the machine has no faults the display will shoe NONE.</p> <p>Use the to scroll through all 10 possible faults.</p>																		

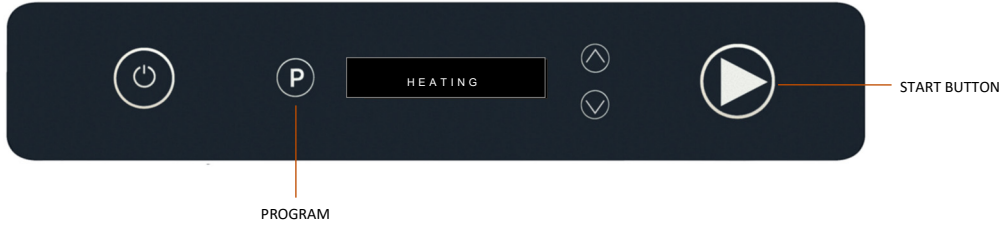

When the machine is heating, washing or regenerating the softener
 Advance forward or cancel by pressing the PROGRAM and START buttons together for more than 8 seconds
 This is used to speed up the testing by the engineer on site.

HEATING
 When the machine is heating you can advance to the machine ready state.

WASHING
 When the machine is washing you can advance to the rinse phase.

SOFTENER REGENERATION
 To cancel the regenerating of the softener.
 When the machine is switched on again the regeneration of the softener will restart.

Pressure switch adjustment

DIFFERENTIAL TIME
 To increase time differential screw in clockwise
 To reduce time differential screw out anticlockwise

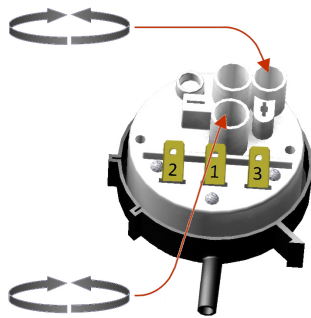

WATER LEVEL
 To increase water level screw in clockwise
 To reduce water level screw out anticlockwise

- 1 - Common supply 230v input
- 2 - N/C normally closed / Not connected
- 3 - N/O normally open

Machines with 2 x pressure switches

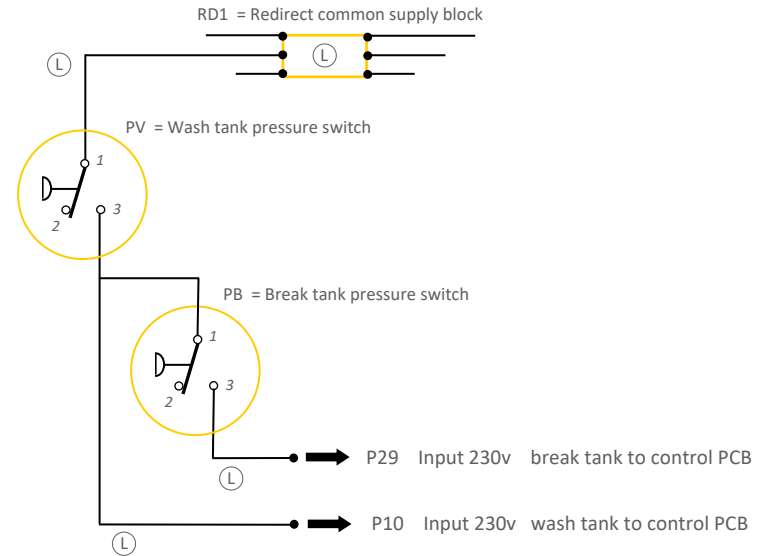

Machines with 1 x pressure switch

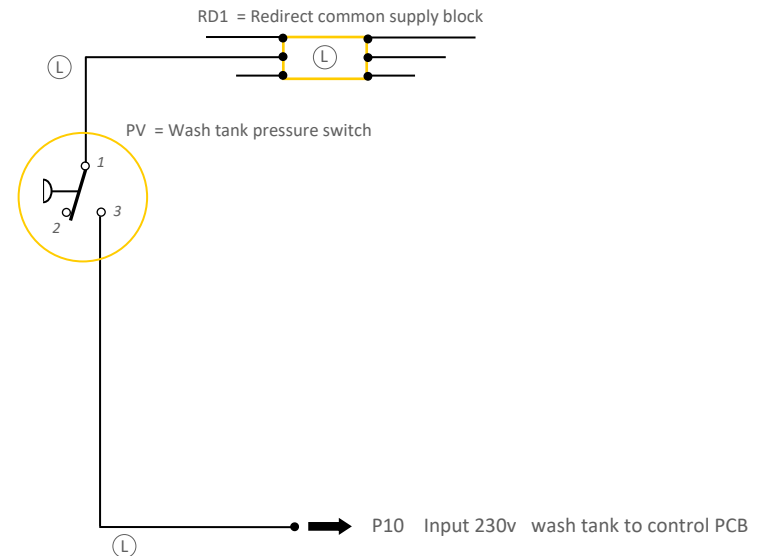

D0012 control PCB

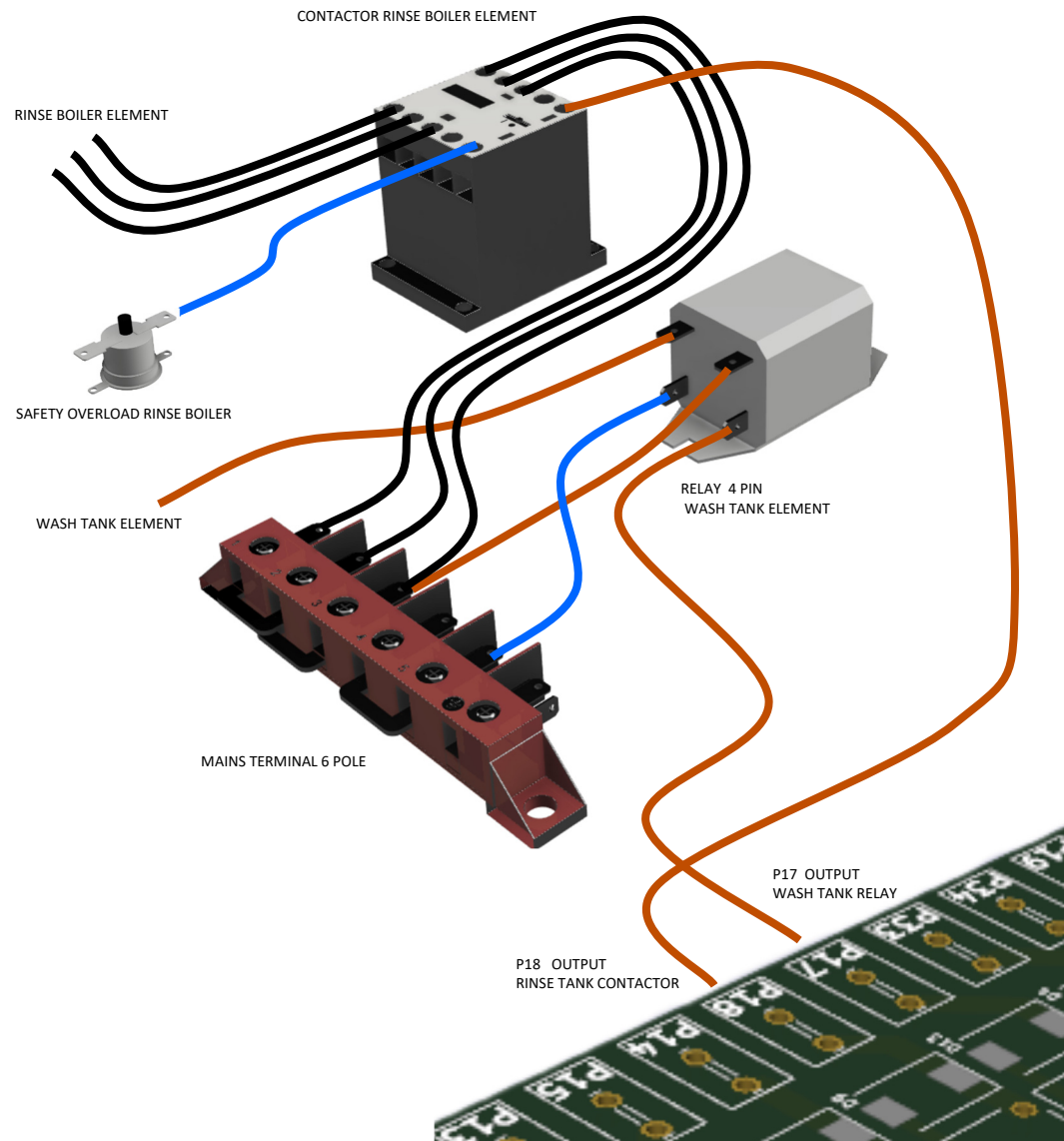
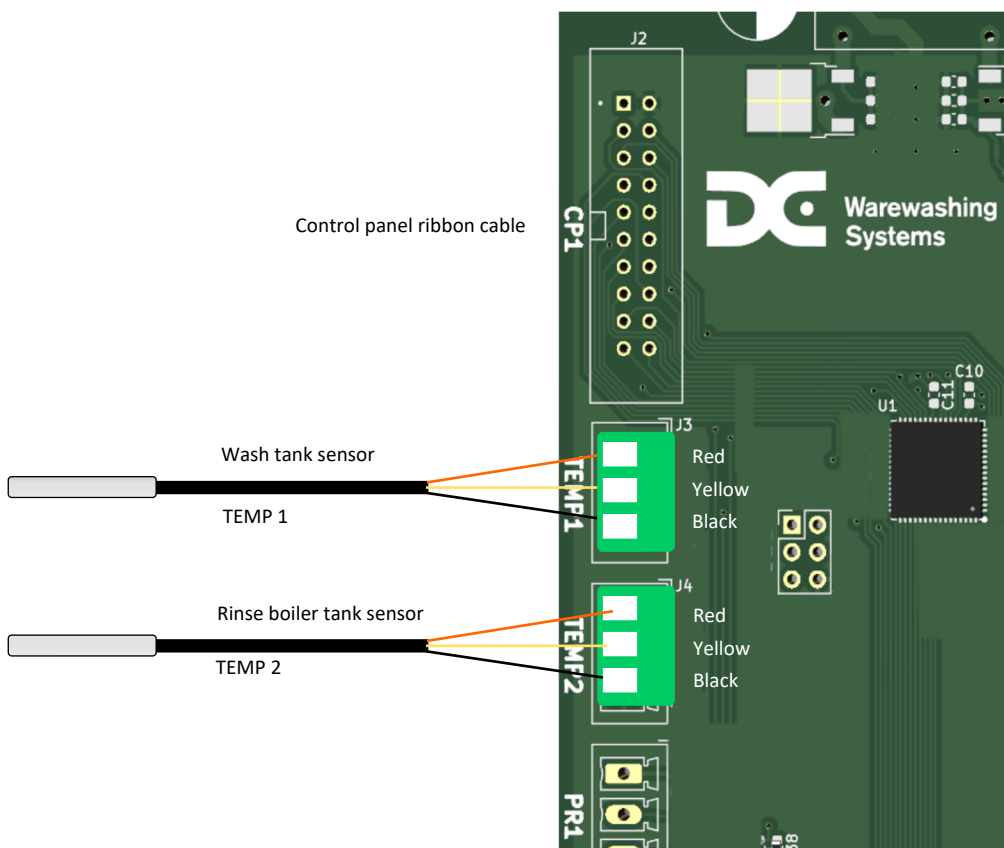

CP0001 FRONT DISPLAY BOARD

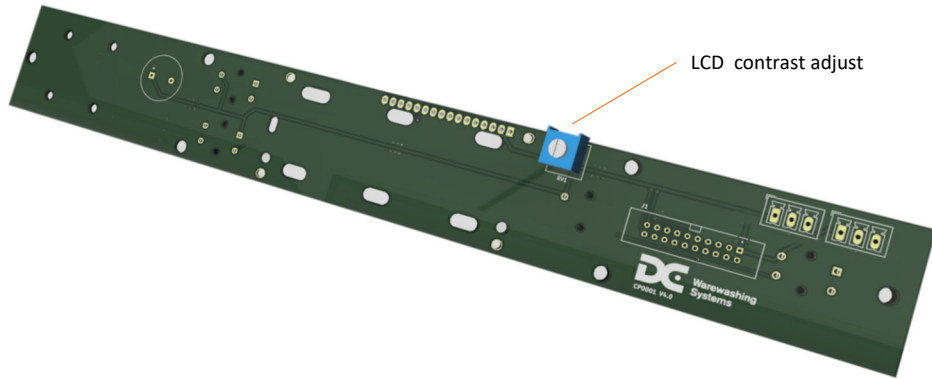

If the LCD display is dark or the text appears faded the LCD contrast can be adjusted. Use a small slotted screwdriver to adjust until the text display is clear.